

# Flameless Electric Air Heaters: Single Pass Quartz Tube Heaters

## Quartz Tube Heaters

Part Number	Type	Dimensions				Wattage at Standard Voltages		
		A	B	C	D	60V	120V	240V
001-10001	OPEN	6.875"	8.25"	.410"	-	115	465	1850
001-10002	NOZZLE	7.875"	9.25"	.410"	.065"	115	465	*
001-10003	OPEN	7.75"	9.125"	.410"	-	210	850	*
001-10004	NOZZLE	8.75"	10.125"	.410"	.065"	210	850	*
001-10005	OPEN	3.875"	5.25"	.410"	-	240	*	*
001-10006	NOZZLE	4.875"	6.25"	.410"	.065"	240	*	*
001-10007	OPEN	3.875"	5.25"	.410"	-	480	*	*
001-10008	NOZZLE	4.875"	6.25"	.410"	.065"	480	*	*
001-10009	OPEN	6.875"	8.25"	.594"	-	290	1150	4650
001-10010	NOZZLE	7.875"	9.25"	.594"	.115"	290	1150	*

Standard outer casing: quartz

\*not recommended  
Standard Wattage Tolerances +5% / -10%

\* **Standard Tubing Adaptors** on **ALL** Series 001 Air Heaters have a **1/4" NPT Female Thread** for use with a compression tube fitting (not supplied).

\* To order an 001 Series Air Heater with a **PLAIN Tubing Adaptor (NO Threads)** use the suffix **"T"** at the end of the Part Number. This adaptor accepts a 3/8" OD Tube.

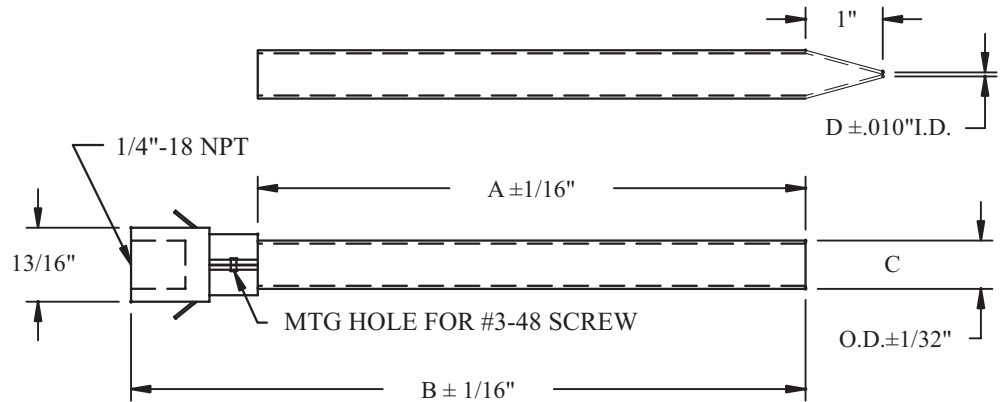

## Performance Characteristics:

Select the heater that matches your application

(See detailed curves in technical section (T) of catalog)

